



LT-100

LT-200

Instruction Manual



Long Range LLC. 26 Tannery Street Franklin, NH 03235

Introduction

The LT-100 and LT-200 are designed for simple set-up and years of reliable service. Both the LT-100 and the LT-200 include a transmitter and a receiver with cables to attach the receiver to your trap and power supply. **Your LT receiver may have either 2 wires** (1 for power and 1 for release) **or 1 single wire**. If your receiver has 2 wires, please refer to the following section for wiring instructions. If your receiver has a single wire, please refer to the the R-4300 wiring diagram (red and black wires are power, green and white wires are release).

Receivers

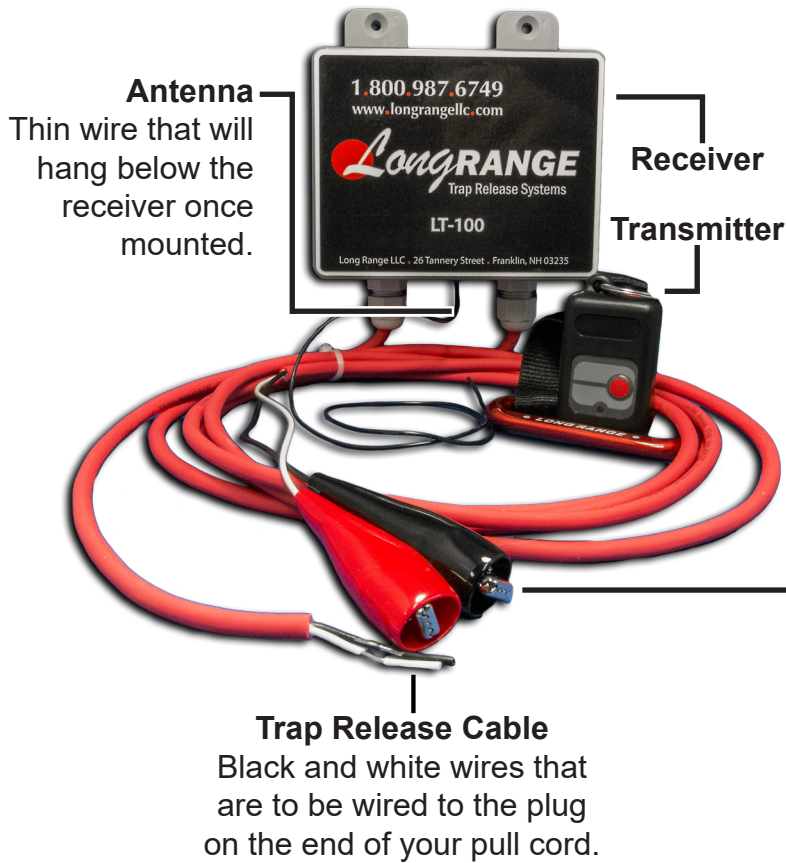

The LT-100 includes 1 receiver with a 1 button transmitter. The LT-200 includes 2 receivers with a 3 button transmitter. The 2 receivers included with the LT-200 will be labeled with Trap 1 and Trap 2. The receivers include 2 mounting holes and it is recommended that the receivers are mounted on a non-metal post, **2-3 feet high** with the antenna hanging below the receiver.

Power Cable

Two wires fitted with red and black battery clips. The red clip will connect to the positive (+) terminal of your battery and the black clip will connect to the negative(+) terminal.

1 Connect Trap Release Cable

The black and white wires from the **Trap Release Cable** will be the first to be connected to the trap machine. Locate the plug on the end of the trap machine's pull cord. Disassemble the plug and take note where the 2 wires are connected. This will be where the black and white **Trap Release** wires will connect. These wires are not polarity sensitive so it does not matter which way you connect them to the plug. Once you have the black and white **Trap Release** wires connected with screw terminals or solder tabs, reassemble the plug and replug it into your trap machine.

If you need to order an additional pull cord plug, refer to the included **Wiring Diagram** and attach the black and white **Trap Release** wires to the connectors of your specific trap plug that show the green and white wires.

2 Connect Power Cable

WARNING: Always stand behind your trap when connecting power or releasing targets.

The **Power Cable** consists of a red and black battery clip. The LT receivers are designed to work with **12 Volts DC ONLY**. If your trap is powered by a 12 volt battery, you may connect the battery clips directly to the battery. If your trap is powered by a 110 volt battery, you will need a transformer to connect the **Power Cable** to the battery. Attach the red clip to the positive (+) battery terminal and the black clip to the negative (-) terminal.

Transmitters

LT-100 Transmitter

LT-200 Transmitter

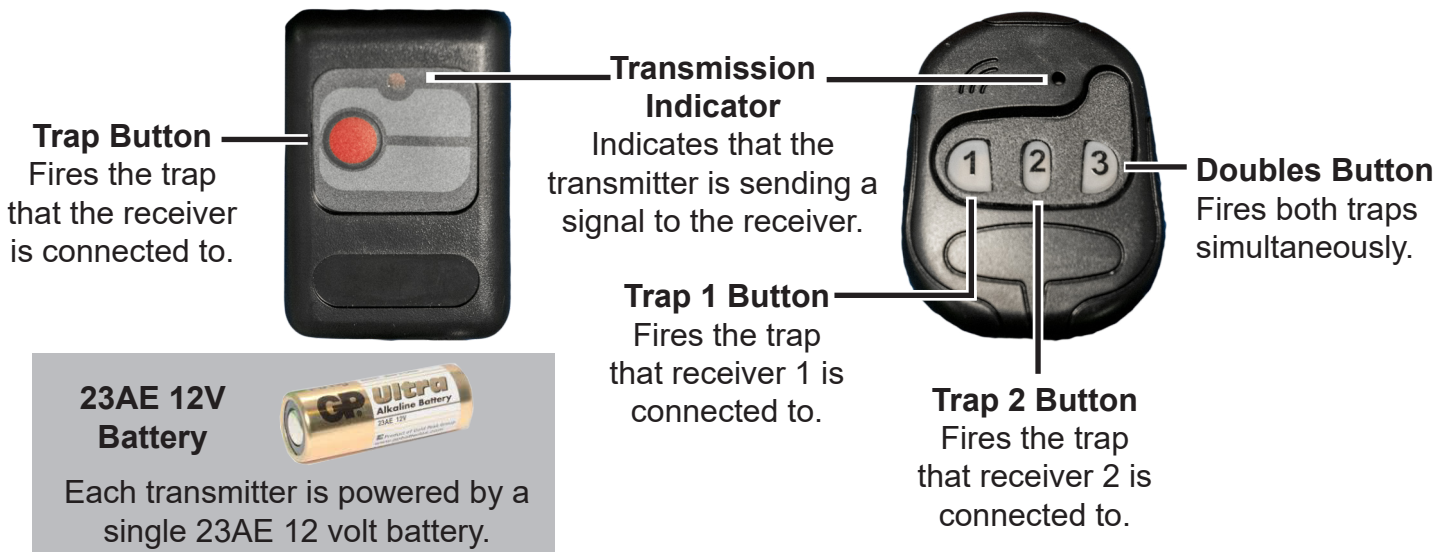

Your transmitters and receivers are preset to the required channel and trap ID to fire the designated trap(s). Simply press the trap button to fire the corresponding trap. The LT-200 has the added abilities to fire a second trap and a true pair. Press button 3 on the LT-200 transmitter to fire both traps simultaneously.

Trouble Shooting

Frequently Asked Questions

Questions	Answers
What should I do if my LT isn't working?	First, ensure that your battery has a charge and the Power Cord wires are securely connected to the battery terminals. Second, if the transmitter's Transmission Indicator is not illuminating, replace the battery. Finally, check the Release Cable's connection. Be sure that the release wires are connected to the plug correctly. Refer to the Wiring Diagram for details on your specific trap machine.

Contact

Please call us with any questions. Your satisfaction is our priority.

Call toll free:
1 800 987-6749, Monday-Friday 8:30am-4:30pm EST

Website:
<http://www.longrangellc.com>

MAIL TO: **Long Range LLC.**
26 Tannery St.
Franklin, NH 03235

Please carefully pack and ship, prepaid and insured, to Long Range LLC.

Please carefully pack and ship, prepaid and insured, to Long Range LLC.